

IN ACTION MEGA



WORKSHOP PRESSES



WORKSHOP PRESSES



BK-05. One piston pump.



BKD-09. Two piston pump for KCK-30AL and KCK-50 models.



Manual screw extension for quick approach and fine adjustment.



A-5552/15: For 15 t presses
A-5552/30: For 30 and 50 t presses.
Plate, adapter and set of punches.. **Optional.**

We manufacture two models: The KMG / KSG Monoblock version and the KCK and KSC presses with cylinder and independent pump.
Compact and functional design that integrates all the hydraulic elements within the chassis, provides a saving in the workshop space and ensures protection in transport.

Supplied fully assembled and ready for work.
Workbench adjustable for height.
Automatic spring return piston.
Different pump options: single or two speed manual, manual-pneumatic and electric pumps, depending on the working speed required (on KCK and KSC models).

Winch to assist easy and rapid handling of the workbench for model KCK-50A.
Set of two V blocks included and legs with boltholes for fixing to the floor.
Pressure gauge with damper to extend its working life. It is positioned at eye-level to make for easy reading.

Safety overload valve on KCK and KSC models.
Hydraulic stroke limitation on KSG, KMG, KCK-30AL y KCK-50A models.

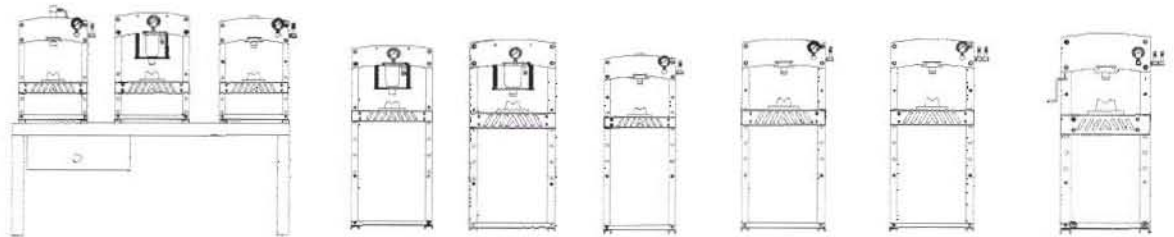
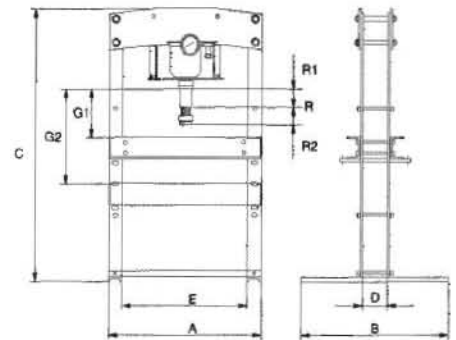

Capacity (t)	10	15	15	15	30	15	30	30	50
Measures (mm)									
A	605	610	605	610	670	605	670	670	710
B	420	420	420	650	650	650	650	650	650
C	940	950	940	1675	1750	1650	1750	1780	1810
D	120	90	120	90	110	120	120	120	145
E	500	500	500	500	550	500	550	550	550
G1 Minimum	160	150	150	150	150	150	180	180	165
G2 Maximum	460	300	450	600	600	600	630	630	615
R1 Hydraulic stroke	135	150	95	150	150	95	95	120	120
R2 Extension stroke	-	75	75	75	75	75	75	75	75
R Total stroke	135	225	170	225	225	170	170	195	195
Weight (kg)	74	72	77	84	136	89	137	139	214
References									
With manual pump	KSC-10A	KSG-15A	KSC-15A	KMG-15A	KMG-30A	KCK-15A	KCK-30A	KCK-30AL	KCK-50A
With BKN-09	-	-	-	-	-	-	-	KCK-30AN	KCK-50AN
With BKN-09+A-5553	-	-	-	-	-	-	-	KCK-30ANE	KCK-50ANE